

CAT: FEET:

TYPE: PROJECT:



Litesphere series (LS) architectural channel is a low voltage version of the classic medium based (MB) architectural channel. We incorporate low voltage T3/4 wedge based LED lamps which produce from 2 to 180 lumens per foot of decorative illumination. Enclosing the LED lamps is a protective clear, frosted, colored, Saber or filament style polycarbonate G16.5 comparable globe. Litesphere sockets are installed into high grade aluminum extruded channel, providing a lightweight rigidity and a solid connection to your structure.

Features

- Surface-mounted linear strip fixture
- Your choice of 12V LS, HO, or VHO lamps (included)
- Heavy-gauge extruded aluminum
- Available in 6", 12", 18" and 24" OC standard spacing
- Wiring and components are concealed
- Anti-corrosion coated (Custom Finished on Request)
- Polished or Satin Aluminum, Powder Coated White or Black
- Custom radial bends
- 2 3/16" x 2 3/16" Standard Profile extrusion available
- Optional chase wiring is available
- Maximum length of single fixture up to 12'
- Configurable for freight optimization
- Pre-wired for quick and easy installation
- Knock-out holes for screws are provided every 24"
- 7/8" diameter knockouts on mounting side (custom optional end cap knockouts)

Technical Information

VHO				
*Lamp Spacing	6" OC	12" OC	18" OC	24" OC
Lumens/ft	180	91	60	45
Watts/ft	1.92	0.96	0.64	0.48
Max Run Lengths	30'	45'	55'	60'
Lumen/watt	94			

HO				
*Lamp Spacing	6" OC	12" OC	18" OC	24" OC
Lumens/ft	29	15	10	7
Watts/ft	0.46	0.23	0.15	0.12
Max Run Lengths	60'	90'	110'	130'
Lumen/watt	46			

STANDARD				
Lamp Spacing*	6" OC	12" OC	18" OC	24" OC
Lumens/ft	11	6	4	3
Watts/ft	0.17	0.09	0.06	0.04
Max Run Lengths	100'	150'	180'	200'
Lumen/watt	40			

*Custom lamp spacing available (consult factory)
Based on 3000K with clear globe

CRI	>80/TYP83
Kelvin Temp	1900K, 2700K, 3000K, 3500K, 4000K, 5000K (+/- 80K) 3SDCM, Amber
Rated life	75,000 hr.
Order increments	1' (12' max)
Operating Voltage	12V DC
Power supply	Class 2
Dimmable	Yes
Finishes**	Satin or Polished Aluminum, Black or White Powder Coated

**Custom paint or anodizing available (consult factory)

Mounting

Knock-out holes for screws are provided every 24" along mounting face of channel. Globes are made of shatterproof polycarbonate and fitted with (1) foam washer for a weatherproof seal.

Applications

Ideal for indoor and outdoor applications. May not be suitable for high salt air environments (consult factory).

Warranty

3 years



Profile Dimensions

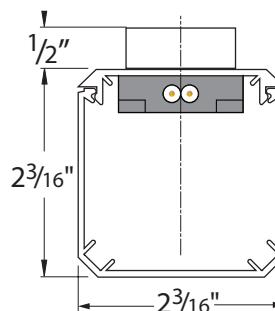

Standard Profile Channel

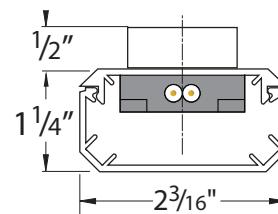

Medium Profile Channel

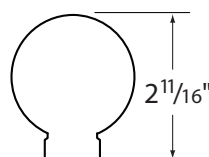

Recommended Power Supplies

CAT NO	APPLICATION	PRIMARY AND SECONDARY	TOTAL WATTAGE / AMPS PER BREAKER	LISTING	DIMENSIONS	ELECTRONIC OR AC MAGNETIC
ADNM-60-1-5-12-D	Outdoor	120-277V AC / 12V DC	60W / 1X5A	cULus	12"W X 12"L X 4"D	Electronic
ADNM-150-2-5-12-D		120-277V AC / 12V DC	120W / 2X5A	cULus	12"W X 12"L X 4"D	Electronic
ADNM-240-3-5-12-D		120-277V AC / 12V DC	180W / 3X5A	cULus	12"W X 12"L X 4"D	Electronic
ADNM-320-4-5-12-D		120-277V AC / 12V DC	240W / 4X5A	cULus	12"W X 12"L X 4"D	Electronic
ADNM-240-1-15-12-D		120-277V AC / 12V DC	180W / 1X15A	cULus	12"W X 12"L X 4"D	Electronic
JT-60-1-5-12-D	Indoor/Outdoor	120V AC / 12V DC	60W / 1X5A	cETLus	4.25"W X 8.50"L X 3.25"D	Magnetic
JTH-60-1-5-12-D		277V AC / 12V DC	60W / 1X5A	cETLus	4.25"W X 8.50"L X 3.25"D	Magnetic
JT-240-4-5-12-D		120V AC / 12V DC	240W / 4X5A	cETLus	8.50"W X 16.00"L X 4.50"D	Magnetic
JTH-240-4-5-12-D		277V AC / 12V DC	240W / 4X5A	cETLus	8.50"W X 16.00"L X 4.50"D	Magnetic

DESCRIPTION	CAT NO	INPUT VOLTAGE	CONTINUOUS MAX VOLTAGE AC	MAX DISCHARGE CURRENT	DIMENSION
HTH Universal Surge Protector	HTH-SURGE	120V - 277V AC	320V AC	10kA (8/20 μ S standard wave)	2.91" L X 1.52"W X 1.16"H

Dimming Interface

DESCRIPTION	CAT NO	APPLICATION	PRIMARY VOLTAGE	SECONDARY VOLTAGE	MAX LOAD	CIRCUIT CAPACITY	DIMENSION
0-10V Dimming Module	AMP-OT-5-D	Indoor	10V DC~48V DC	10V DC~48V DC	96W @ 24V DC 60W @ 12V DC	5A	5.9"L X 1.61"W X 0.78"H

Ordering Information

PRODUCT CODE	SOCKET TYPE	SOCKET COLOR	LAMP SPACING	FINISH	LED COLOR	GLOBE COLOR	REQUIRED POWER SUPPLY
<input type="text"/>	<input type="text"/>	<input type="text"/>	<input type="text"/>	<input type="text"/>	<input type="text"/>	<input type="text"/>	PSU
AC = Standard Channel AM = Medium Channel	LS = Standard LH = High Output LV = Very High Output	B = Black W = White	06 = 6" OC 12 = 12" OC 18 = 18" OC 24 = 24" OC	PA = Polished Aluminum* SA = Satin Aluminum BK = Black Powder Coat WH = White Powder Coat	19 = 1900K 27 = 2700K 30 = 3000K 35 = 3500K** 40 = 4000K 50 = 5000K*** AM = Amber***	C = Clear F = Frosted Y = Yellow R = Red O = Orange G = Green B = Blue P = Purple Z = Varied Colors S = Saber A = Flare	See Above
<p>*Consult Factory for extended lead time. **3500K Recommended for colored spheres. *** VHO Only</p>							

Mounting Accessories

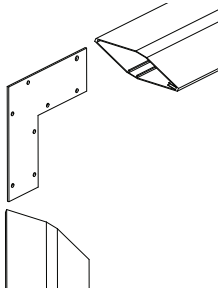

INTERNAL 90° BRACKET
AC-90
 Flat 90 (Standard)
AM-90
 Flat 90 (Medium Profile)

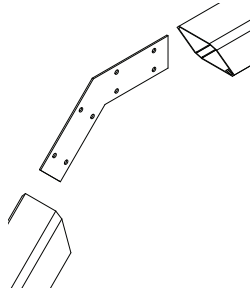

INTERNAL 45° BRACKET
AC-45
 45° Bracket (Standard)
AM-45
 45° Bracket (Medium Profile)

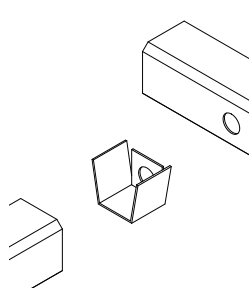

INTERNAL T-BRACKET
AC-T
 T Bracket (Standard)

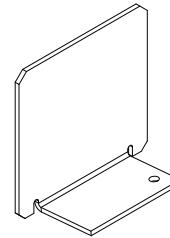

END CAPS
STANDARD PROFILE
AC-EC-SA
 Satin Aluminum
AC-EC-PA
 Polished Aluminum
AC-EC-PW
 Powder Coated White
AC-EC-PB
 Powder Coated Black

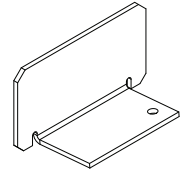

END CAPS
MEDIUM PROFILE
AM-EC-SA
 Satin Aluminum
AM-EC-PA
 Polished Aluminum
AM-EC-PW
 Powder Coated White
AM-EC-PB
 Powder Coated Black

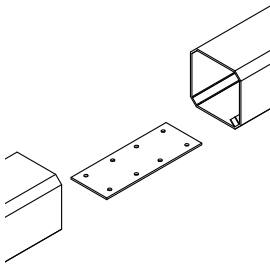

INTERNAL CONNECTOR
AC-180
 Internal Connector (Standard)
AM-180
 Internal Connector (Medium Profile)

Replacement Components

REPLACEMENT GLOBES

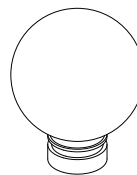

REPLACEMENT LEDS

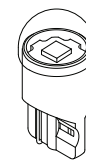

Standard & High Output

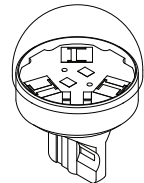

Very High Output

Channel Configurations

Factory Radius

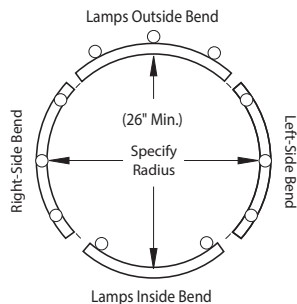

RADIUS OPTIONS
RADIUS
 Radius bend set up charge (Over 3' Radius)
RADIUS-3
 Radius bend set up charge (Under 3' Radius)
R-UNITS
 Radius unit charge, Per 8' Max length
AC-RADIUS
 Internal Bracket Standard Channel
AM-RADIUS
 Internal Bracket Medium Channel

Factory Miters

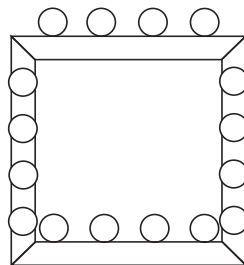

NOTE: Dimensional drawings with lamp orientation required.
AC-MITER
 Factory Miter Cut Standard Profile
AM-MITER
 Factory Miter Cut Medium Profile

- LS-CG**
Clear
- LS-FG**
Frosted
- LS-SG**
Saber
- LS-AG**
Flare
- LS-YG**
Yellow
- LS-RG**
Red
- LS-OG**
Orange
- LS-GG**
Green
- LS-BG**
Blue
- LS-PG**
Purple

- | | |
|---|---|
| STANDARD | HIGH OUTPUT |
| LSL-19-S-12
12V Wedge base
1900K | LSL-19-H-12
12V Wedge base
1900K |
| LSL-27-S-12
12V Wedge base
2700K | LSL-27-H-12
12V Wedge base
2700K |
| LSL-30-S-12
12V Wedge base
3000K | LSL-30-H-12
12V Wedge base
3000K |
| LSL-35-S-12
12V Wedge base
3500K | LSL-35-H-12
12V Wedge base
3500K |
| LSL-40-S-12
12V Wedge base
4000K | LSL-40-H-12
12V Wedge base
4000K |

- VERY HIGH OUTPUT**
- LSL-19-V-12**
12V Wedge base
1900K
- LSL-27-V-12**
12V Wedge base
2700K
- LSL-30-V-12**
12V Wedge base
3000K
- LSL-35-V-12**
12V Wedge base
3500K
- LSL-40-V-12**
12V Wedge base
4000K
- LSL-50-V-12**
12V Wedge base
5000K
- LSL-AM-V-12**
12V Wedge base
Amber